



Font: Feta Size: 8 Spacing: 100%



Mod6rate G F G C G

click on view, and chose
Velocity Property Ruler

Note!, layout Mode must be on linear
Mode

And then you will get the dialog up below

And then by right click on this line, you'll get up and
menu, there you can choose:
Draw Property Line.

and then you click with the left there you want to start
the change of volum and hold the butom in, at the
same time you drag it over the line

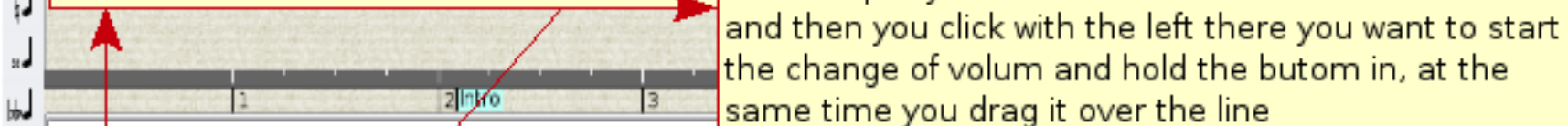

velocity